



Chapter 6-2

Landscape Plan

LEGEND

- A WETLAND PARK
- B LINEAR PARK
- C GREEN STREET
- D RAIN GARDEN
- E INTERIOR COURTYARDS
- F COMMUNITY GARDEN
- G BUS STOP
- H FIRE LANE
- I PLAZA

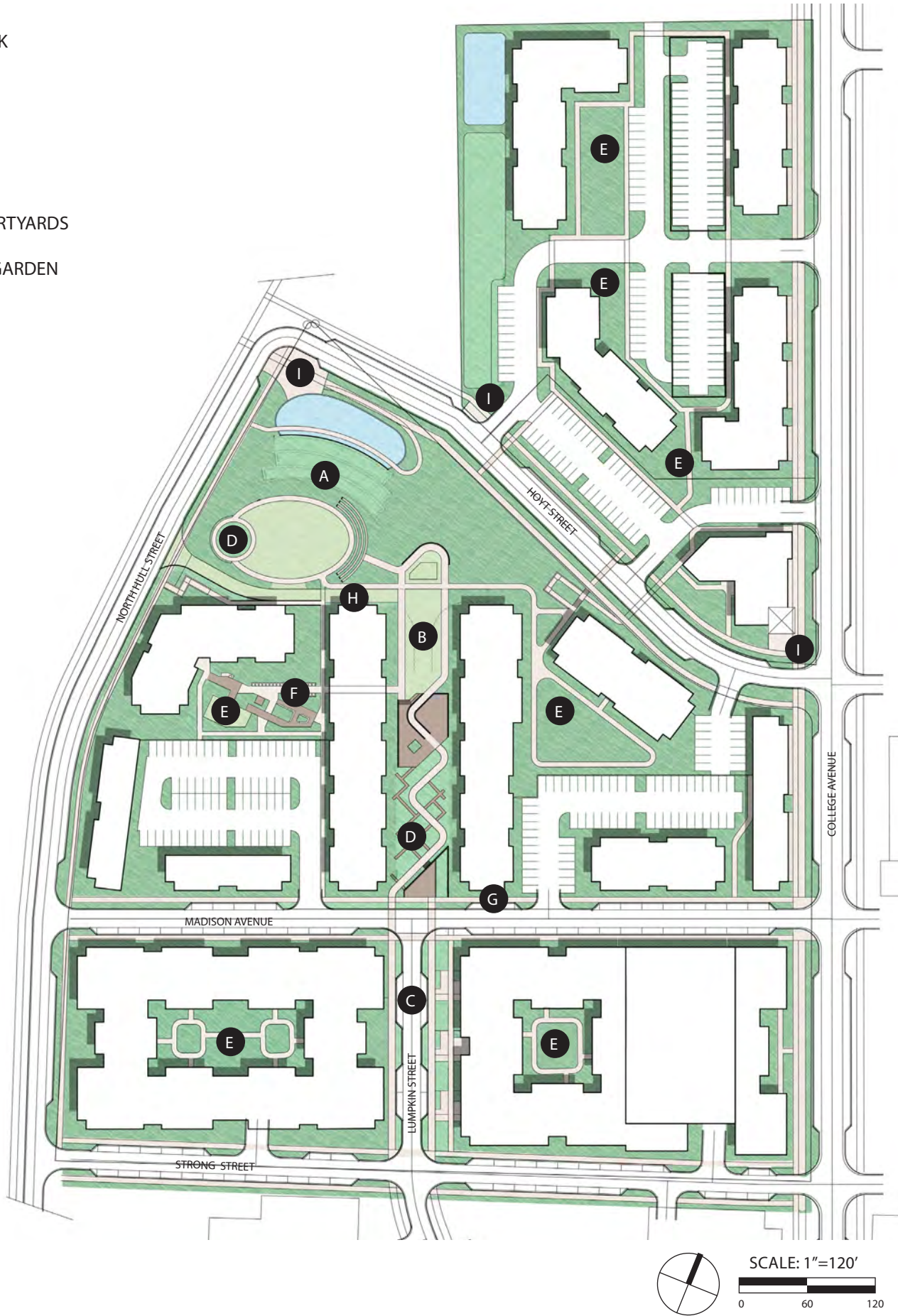

NEIGHBORHOOD GOALS

- Safety for pedestrians
- Open space throughout
- Integrate Art and History
- Connectivity - Pulaski Trail, Lay Park and Downtown
- Playgrounds and active use

USES LEGEND

- GREEN STREETS
- COMMUNITY PARKS
- GREEN INFRASTRUCTURE
- WATER BODY

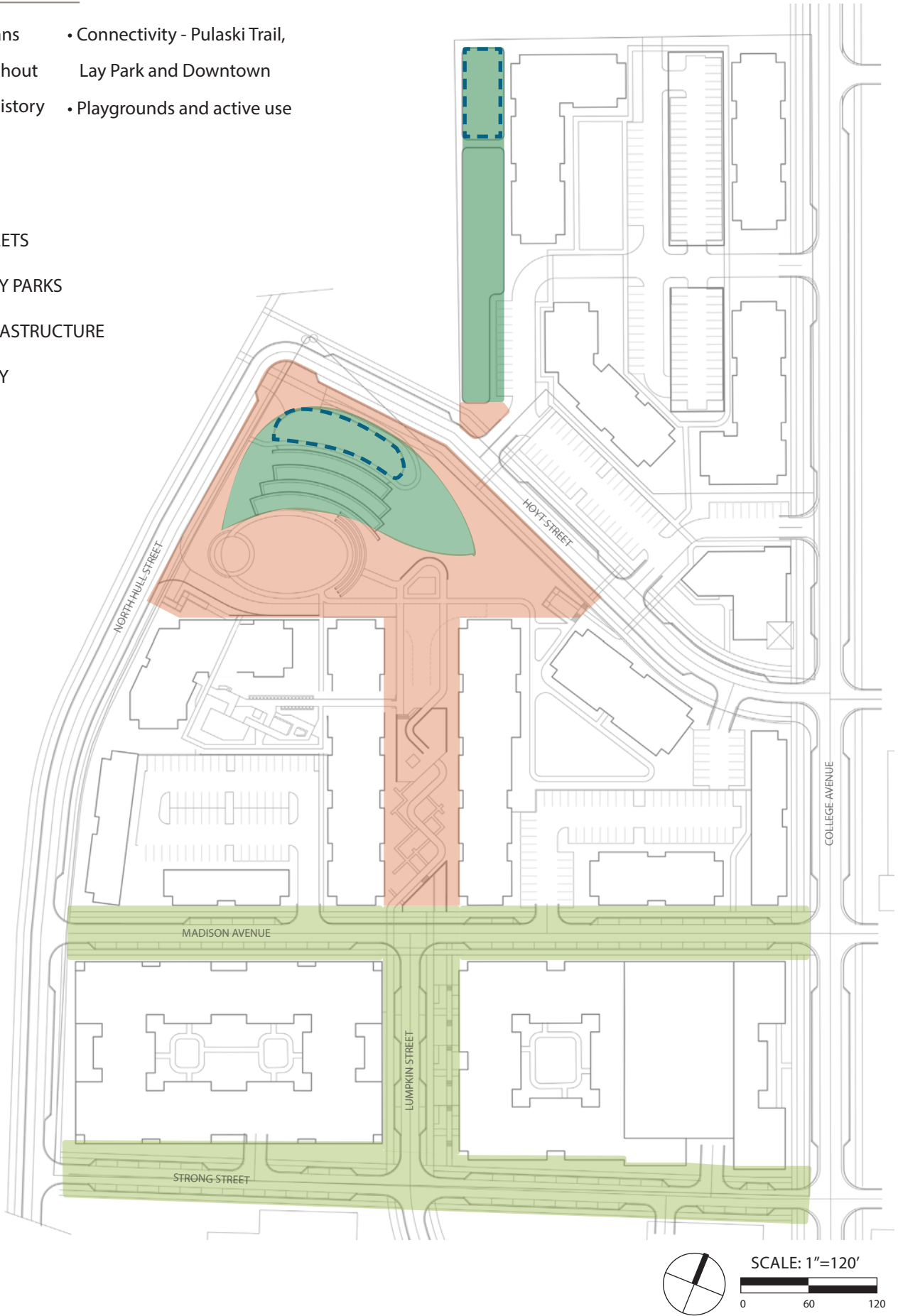

LUMPKIN STREET

INVITING - RETAIL - POCKET PLAZAS



- Complete Street
- Active ground floor uses front the expanded streetscape featuring gathering spaces and rain gardens
- Stormwater infiltration planters improve water quality and reduce peak discharge from the street
- Triple row of street trees provide more shade and offset the urban heat island effect

GREEN STREETS

CURBLESS PLANTERS - OPEN VIEWS - MULTI-USE - NODES



- Complete Streets – Lumpkin St, Madison St, Strong St, College Ave, Hoyt St, and Hull St
- Integrate stormwater management into streets
- Street trees within infiltration planters are present on all streets on a regular spacing with generous soil volume and a connected under-drain system

GREEN SPACES

PUBLIC - OPEN LAWNS - ACTIVITIES



- Open spaces with hardscape and plantings provide room and amenities for small or large gatherings
- Pedestrian connections are dominant throughout community
- Dedicated space for art display are provided throughout at key vistas
- Neighborhood stories are celebrated with signs and markers

WETLAND PARK

RESTORATIVE - SERENE - TIERED - BIOPHILIA



- Provides short term storage of runoff from the watershed including the quadrangle bound by College Ave, Dougherty Ave, Hoyt St and Hull St
- Deals with flooding and improves runoff water quality going into Pulaski Creek
- Provides usable open space for programming community gathering and activities

LINEAR PARK

CONNECTIVE - ACTIVE - ART - HISTORY



- Shared open space for residents and community provides a pedestrian connection between Lumpkin Street (downtown) and the Stormwater Park connector to Lay Park and the Pulaski Trail
- Terraces provide space for gatherings, art exhibits, historic references, and rain gardens
- Ground level units front the park

RAIN GARDENS

ENGAGING - FUNCTION - EDUCATIONAL



- Improves runoff water quality from roofs and paving
- Offers a seasonally changing plant ecoscape with a high aesthetic value
- Increases biodiversity through a range of native plant habitats

KEY PLAN

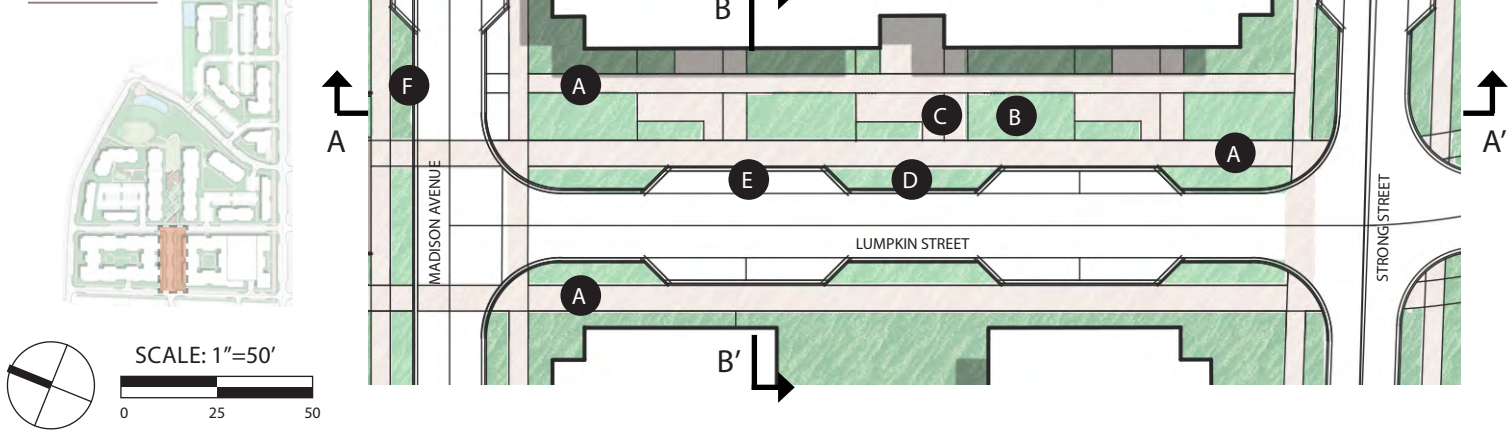

LUMPKIN STREET LEGEND

- A SIDEWALK
- B STEPPED PLANTER
- C POCKET PLAZA
- D CURBLESS PLANTER
- E PARALLEL PARKING
- F BUS STOP



LUMPKIN STREET SECTION B

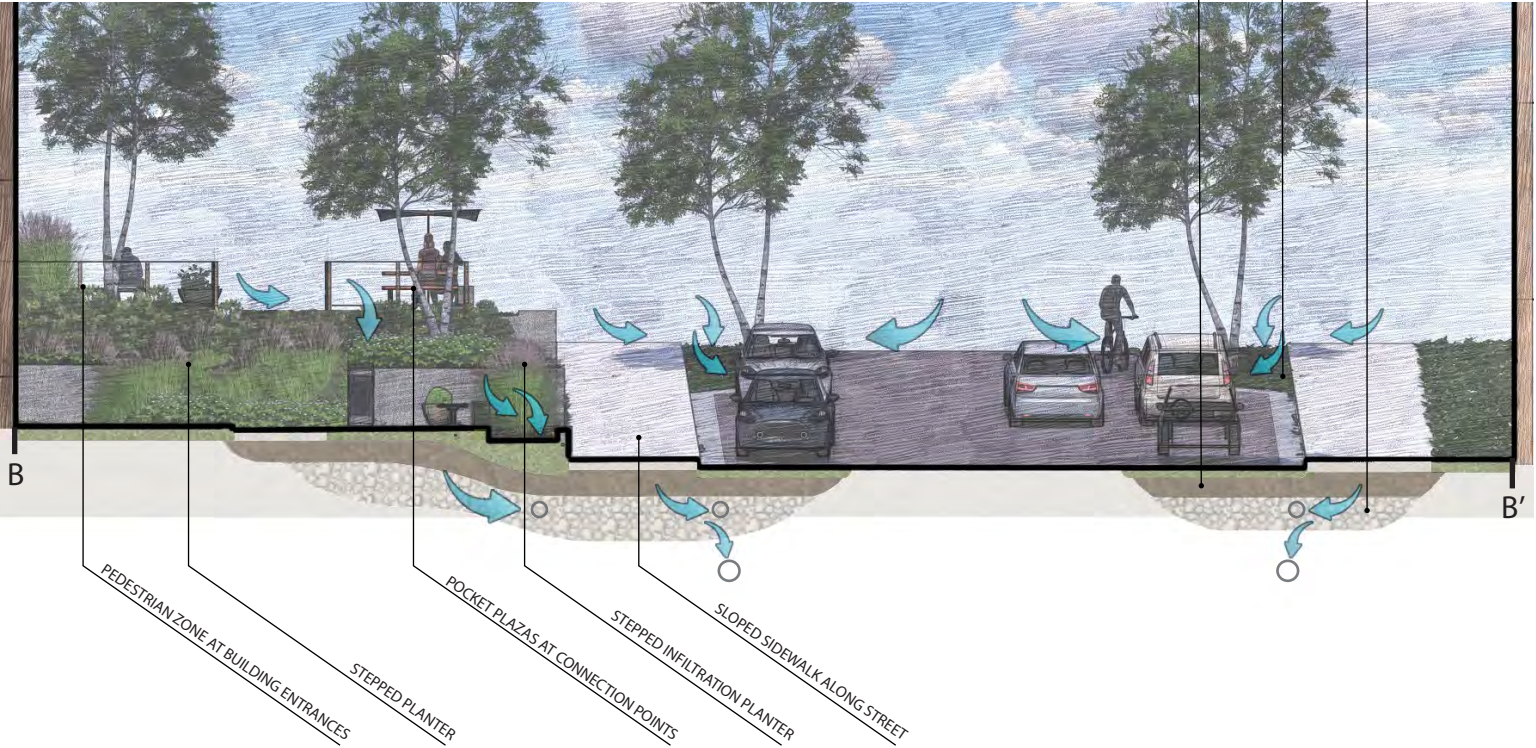

WETLAND PARK

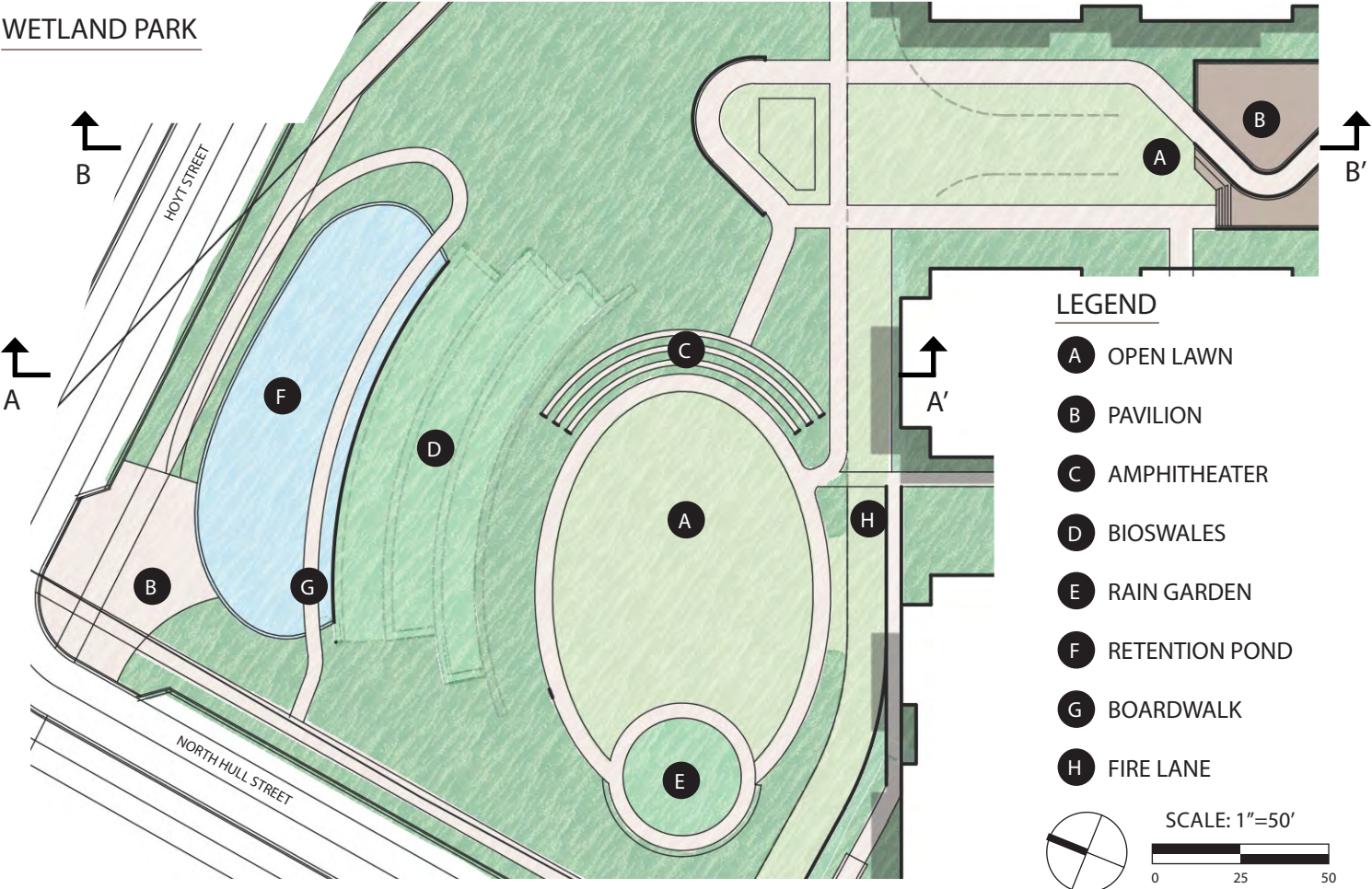

LEGEND

- A OPEN LAWN
- B PAVILION
- C AMPHITHEATER
- D BIOSWALES
- E RAIN GARDEN
- F RETENTION POND
- G BOARDWALK
- H FIRE LANE

WETLAND PARK SECTION A

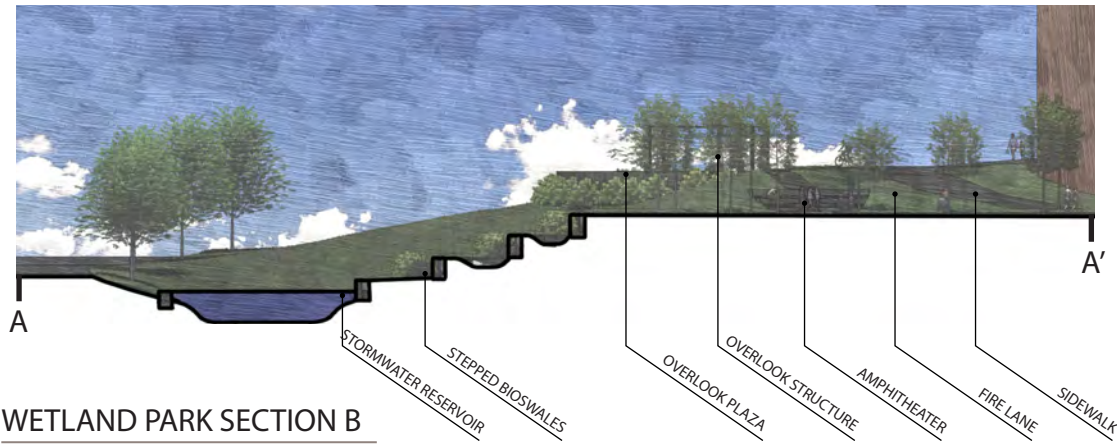

WETLAND PARK SECTION B

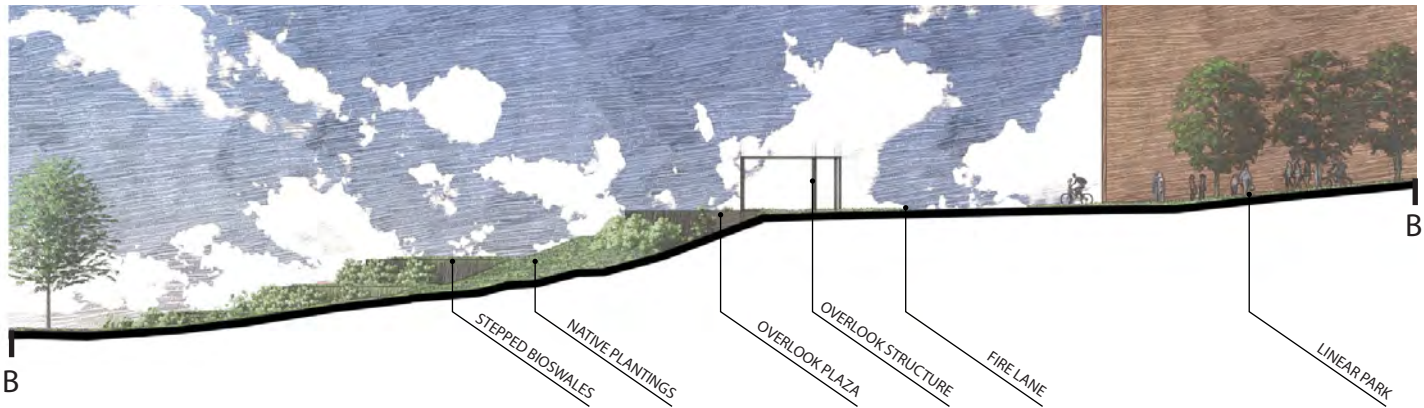

RESIDENT GOALS

- Highlight neighborhood history and integrate art
- Exceeds minimum amenity requirements
- Playground

USES LEGEND

- INTERIOR COURTYARDS
- BLOCK 'A' COURTYARD EXHIBIT

BLOCK 'A' AMENITIES

- A PLAYGROUND
- B ADULT EXERCISE STATIONS
- C OUTDOOR WORK STATION
- D COMMUNITY GARDEN
- E OUTDOOR KITCHEN

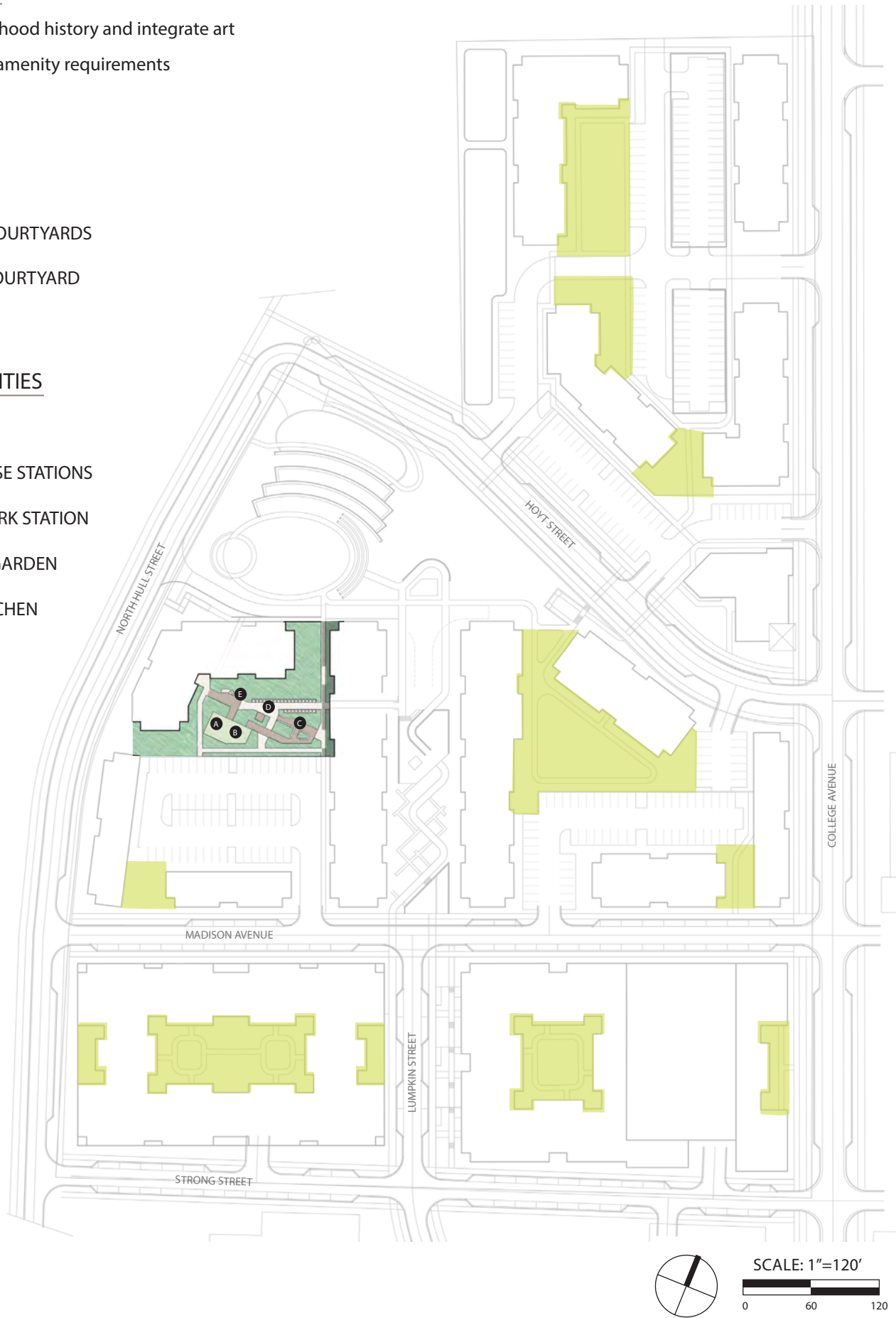

GATHERING SPACES



- Pedestrian connections are present throughout community
- Patios and terraces provide space for technology, furniture, play equipment, and community gardens
- Open spaces with hardscape and plantings provide room and amenities for small gatherings as well as individual use and social distancing

PLAZAS - PATH NETWORK - COMMUNITY

COMMUNITY GARDEN



- Gardens are placed to take advantage of favorable sunlight conditions to optimize yield
- Modular system facilitates change over time and varying levels of participation
- Garden serves as multi-function open space

SCALABLE - SEASONAL - FLEXIBLE

ACTIVE SPACES



- Durable site furniture is provided for all abilities play, exercise, bike parking, and resting
- Open space accommodates small group activities and resident programs

ADULT EXERCISE STATIONS - PLAYGROUND - TOT LOT